

1 Dismount and pull out the encoder arm guard connecting-clamp marked with number 1.

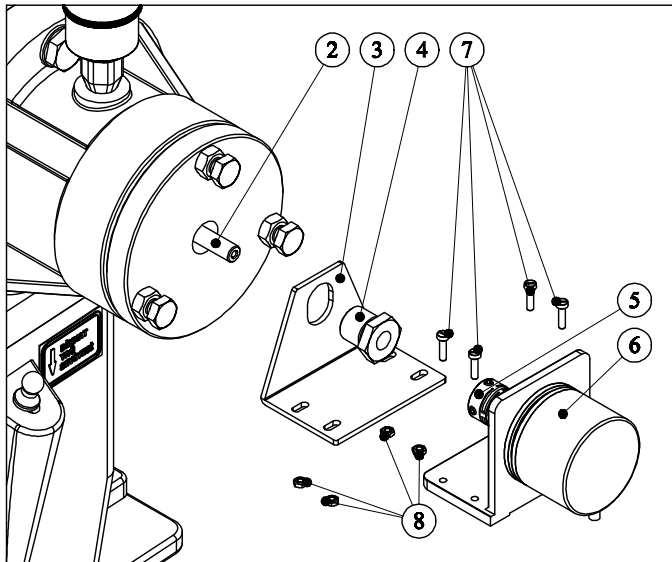

Assembly encoder assembly plate (No:3) and testing connection-clamp (No:4) and mount these to thrust ball cover as they pass through arm axis (No:2) And then center the encoder clamp-coupling (No:5) with arm axis (No:2) and encoder arm (No:6) so that they all stand at the same axis. Fix the encoder to the assembly plate with M3 screws (No:7) and M3 turn screws (No:8) squeeze tightly the testing connecting-clamp (No:4) with a key, after doing the central settings.

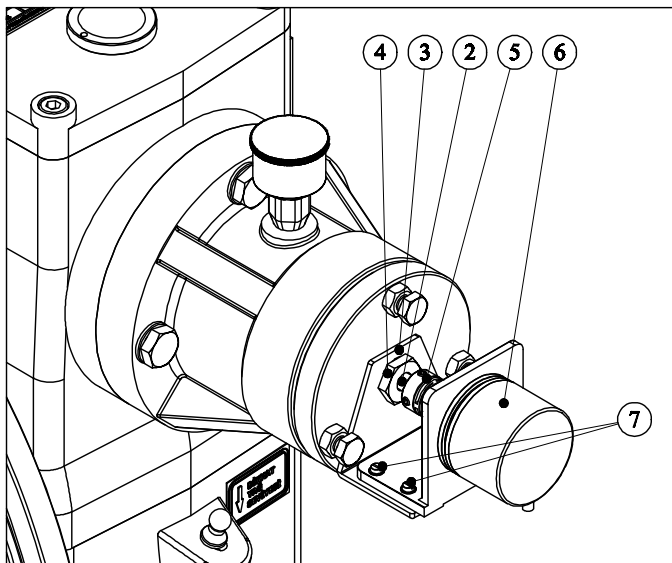

Note : a) Our company has the right to change without declaration.